

**Southwest O Scale and
Oklahoma Narrow Gauge Combined Meet
Oklahoma City, Oklahoma October 7 - 8 , 2006**

O SCALE 2 Rail and All Scales of Narrow Gauge

Buy - Sell - Trade

Where

Oklahoma Christian University, 2501 E. Memorial Road, Oklahoma City, Ok 73013
Easy to find: From Kilpatrick Turnpike, exit at Eastern Ave., go north almost a mile to Memorial Road,
go east on Memorial about one half mile, University will be on the north side. See map on reverse side.

Room Reservations

Sleep Inn, 3608 S. Broadway Extension, Edmond, OK 73013 (Closest Motel)
Call: 405-844-3000, Fax: 405-844-3086, email: JRGEIS@aol.com
Train Meet Rate including taxes: \$80.53, includes full breakfast (Cut-Off Date: Sep 22, 2006)
(See attached sheet for list of other Motels)

FRIDAY, SEPTEMBER, 6
5 PM to 9 PM: Dealer Setup

SATURDAY, October 7

7 AM to 9 AM: Dealer setup

9 AM to 5 PM: Trade hall open

5 PM: Dinner (purchase own food from cafeteria)

Following meal, Slide and Video show (bring your favorites)

SUNDAY, OCTOBER 8

7 AM to 9 AM: Dealer setup.

9 AM to end of trading: Trade hall open

The meet is about one mile from our O/On3 club layout which will be open during the meet. Our O scale modular layout will be in operation at the meet. There will be a popular vote model contest and we encourage everyone to bring a model. Clinics will be held on Saturday. Check www.okng.org for special Narrow Gauge events.

CONTACT: George Wallace, Home: 405-751-7649, Cell: 405-818-2277, Fax: 405-755-4894
e mail: thudchief1@sbcglobal.net, website: www.okng.org

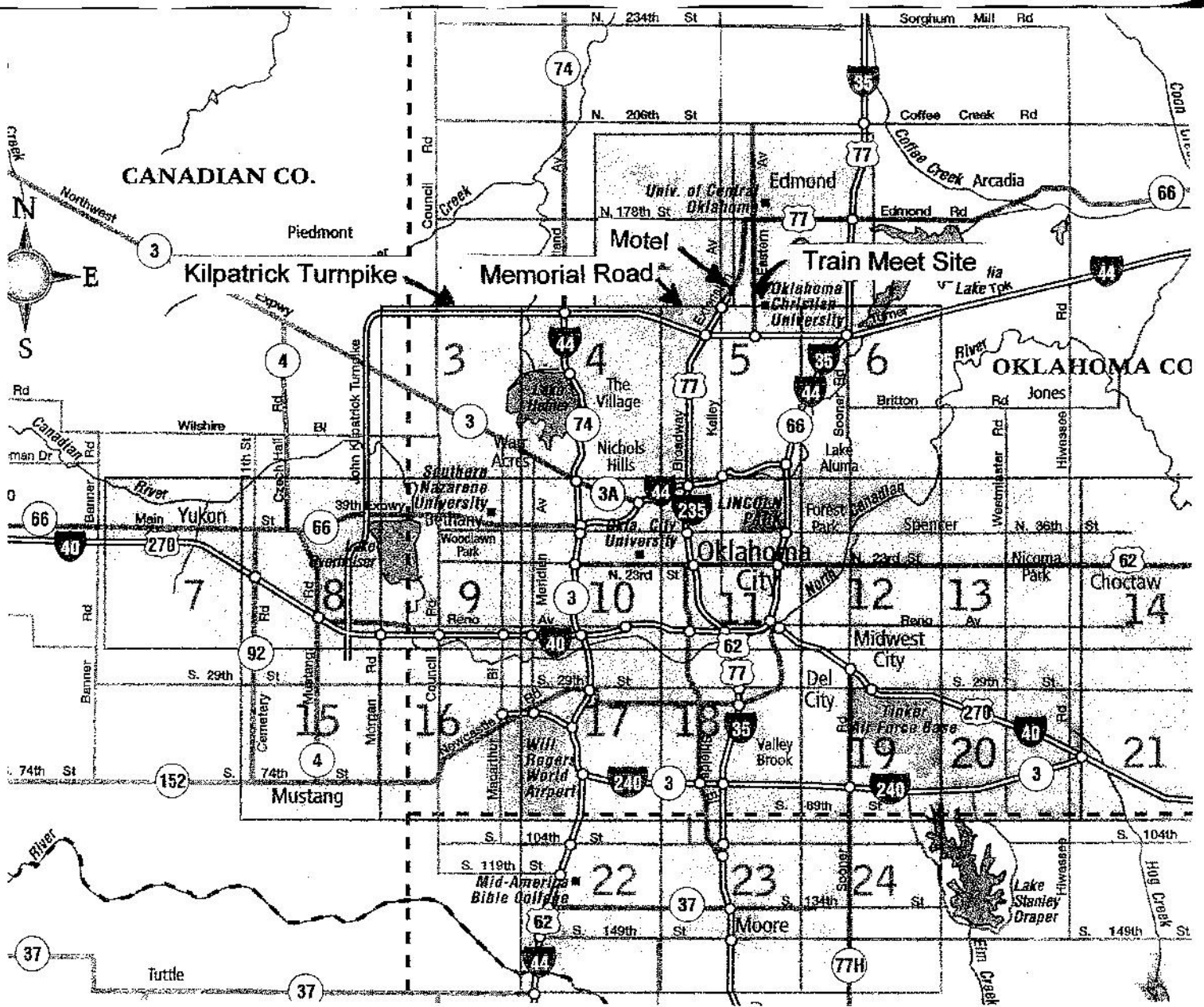

From Kilpatrick Turnpike, exit at Eastern Avenue, go north almost a mile to Memorial Road, go east on Memorial about one half mile, University will be on the north side. Follow the TRAIN SHOW signs from University Main Entrance to Edward L. Gaylord University Center

Motels

Here is a list of Motels by price and distance from the meet.
All Prices include taxes and are for rooms with two queen size beds.

	Price	Miles Away
Sleep Inn		
3608 S. Broadway Extension, Edmond, OK 405-844-3000	\$80.53	1.5
This is a great hotel and closest to the meet. The special O Scale Meet price includes a full breakfast.		
Stratford House Inns		
3020 S. Broadway Extension, Edmond, OK 405-340-5693	\$54.75	1.5
Motel 6		
12121 N I-35, OKC, OK 405-478-4030	\$45.53	2.1
Quality Inn		
12001 N. I-35, OKC, OK 405-478-0400	\$56.78	2.2
Economy Inn		
12005 N. I-35 Service Rd, OKC, OK 405-478-9292	\$45.53	2.2
Super 8 Motel		
11935 N. I-35 Service Road, OKC, OK 405-478-8288	\$62.68	2.2
Best Western Memorial Inn and Suites		
1301 West Memorial Road, OKC, OK 405-286-5199	\$102.57	3.5
Fairfield Inn Marriott		
13520 Plaza Terrace, OKC, OK (W. Memorial Road) 405-755-8686	\$102.57	5.0
Hampton Inn		
13500 Plaza Terrace, OKC, OK (W. Memorial Road) 405-752-7070	\$102.57	5.0
La Quinta.		
3003 West Memorial Road, OKC, OK 405-755-7000	\$147.03	5.7
AmeriSuites		
3201 W. Memorial Road, OKC, OK 405-749-1595	\$169.83	6.0

See reverse side for Hobby Shops and Attractions

Hobby Shops

WHISTLE STOP TRAINS, 1313 West Britton Rd, OKC Ph: 405-842-4846

O scale estate sales, videos, paint, books and scratch building supplies, Lionel, K-Line

WOODWARD'S ARTS, CRAFTS, HOBBIES, 4401 W. Memorial Rd, OKC Ph: 405-751-4994

Full line of paint and scratch building supplies, Lionel

THE HOBBY SHOP, 9311 N. Pennsylvania, The Village (1/2 mile west of the The Whistle Stop),

405-810-2960. A new shop with lots of classic Lionel, paint and building supplies.

TRADITIONS, GIFTS & HOBBIES, 29 W. 15th St, Edmond 405-340-7756

New shop. Lionel, all scales, vehicles, figures, paint & scratch building supplies

Train Related and Other Activities in the Oklahoma City Area

O SCALE LAYOUT. Our club 30' by 26' layout will be open both Sat and Sun.

It has two levels with narrow gauge on the top level and dual gauge on the bottom. Track work is almost complete and great work has been done this year on the upper level scenery.

Directions available at the meet. Host - Mark Gardner, cell: 405-203-4002

OKLAHOMA RAILWAY MUSEUM. It is located at I-35 and Grand Blvd. on the east side of the city. Museum has locomotives, equipment and a 1.9 mile ride. 405-424-8222

OMNIPLEX. This museum has a large operating O scale Lionel layout plus a lot of scale O equipment in display cases. Location - NE 52nd St. and M.L. King Blvd. Open daily 9 - 5, Sat. 9 - 6, Sun. 11 - 6. Adult \$7.50, senior \$6.75. 405-602-6664

EL RENO TROLLEY. The city of El Reno (about 30 miles west of Oklahoma City) has a trolley line featuring a restored 1924 streetcar. It runs from 10am - 4pm Wed thru Sat. and 1pm - 4pm Sun. It departs from the El Reno Railroad museum which is located in the old Rock Island station. 405-262-5121 for schedule and ticket info.

YUKON TROLLEY MUSEUM. Third and Main Street, Yukon

Old Oklahoma Railways Station, West side of tracks, across street from "Yukon's Best Flour" elevator, pictures, fare boxes, ticket dater, etc.

AMTRAK'S HEARTLAND FLYER. It's still running daily between Fort Worth and Oklahoma City. Rumors of its death have been premature.

Departs Fort Worth	5:25 pm	Departs Oklahoma City	8:25 am
Arrives Oklahoma City	9:39 pm	Arrives Fort Worth	12:39 pm

AMTRAK Reservations 1-800-872-7245 (1-800-USA-RAIL), www.amtrak.com

OKLAHOMA CITY NATIONAL MEMORIAL. The Memorial to the victims of the Murrah Building Bombing is open 24 hours daily. The adjacent Museum is open 9 am - 6 pm Mon - Sat, 1 pm - 6 pm Sun. 405-235-3313

NATIONAL COWBOY HALL OF FAME & WESTERN HERITAGE CENTER. Located on I-44 near M.L. King Blvd. Open everyday 9 am - 5 pm. 405-478-2250

Please call George Wallace if you have any questions about these or other attractions. 405-751 7649

See reverse side for list of Motels