

Southwest O Scale & Oklahoma Narrow Gauge Group Combined Meet Oklahoma City, Oklahoma October 1 & 2, 2004

All O SCALE 2 Rail and 3 Rail (Scale compatible) and Narrow Gauge (all scales) modelers and dealers are cordially invited to the Southwest O Scale and Oklahoma Narrow Gauge Group Combined Meet. We combined the two meets as a way to better utilize our resources. We anticipate increased numbers of sellers and buyers. We have moved the meet site from that of our previous shows. Our new location is larger and dealers will find setup much faster and easier. The meet is about one mile from our club layout which will be open during the meet.. There will be at least two modular layouts (O Scale, O Traction or Narrow Gauge). There will be a popular vote model contest and we encourage everyone to bring a model. Clinics will be presented by Narrow Gauge modelers both days. See attachment for other attractions.

WHERE: Oklahoma Christian University, 2501 E. Memorial Road, Oklahoma City, Ok 73013
 Easy to find: From Kilpatrick Turnpike, exit at Eastern Ave., go north almost a mile to Memorial Road, go east on Memorial about one half mile, University will be on the north side. See map on reverse side.

ROOM RESERVATIONS: Sleep Inn, 3608 S. Broadway Extension, Edmond, OK 73013
 Call: 405-844-3000, email JRGEIS@aol.com
 Train Meet Rate: \$68 + tax, includes full breakfast.

FRIDAY, OCTOBER 1
 9 AM to 1 PM: Dealer and modular layout setup.
 1 PM to 5 PM: Trade hall open
 Clinics by Narrow Gaugers
 Trinity Industries tour (tentatively 2 PM)
 5 PM to 7 PM: Self pay dinner (cafeteria adjoins meet room)
 7 PM to end: Slide and video show (bring your favorites)

SATURDAY, OCTOBER 2
 7 AM to 9 AM: Dealer setup.
 9 AM to 3 PM: Trade hall open
 Clinics by Narrow Gaugers

Visit our progressing O and On3 layout Friday through Sunday. (Now operating)
 CONTACT: George Wallace, Home: 405-751-7649, Cell: 405-818-2277, Fax: 405-755-4894
 e mail: thudchief1@aol.com
 Show website: www.okng.org

***** CUT HERE AND PLEASE MAIL IN BY SEP. 20 *****

Name _____ Phone: _____

Street Address _____

City _____ State _____ ZIP Code _____

Number of Registrations () @ \$15 each (Includes Spouse & Children)	\$ _____
I need () tables. First 2 tables - \$10 each, \$5 each additional table	\$ _____
Make checks payable to and mail to:	Total \$ _____

George Wallace
 11937 Stratford Drive
 Oklahoma City, OK 73120

General Admission at door for one day only - \$5.00

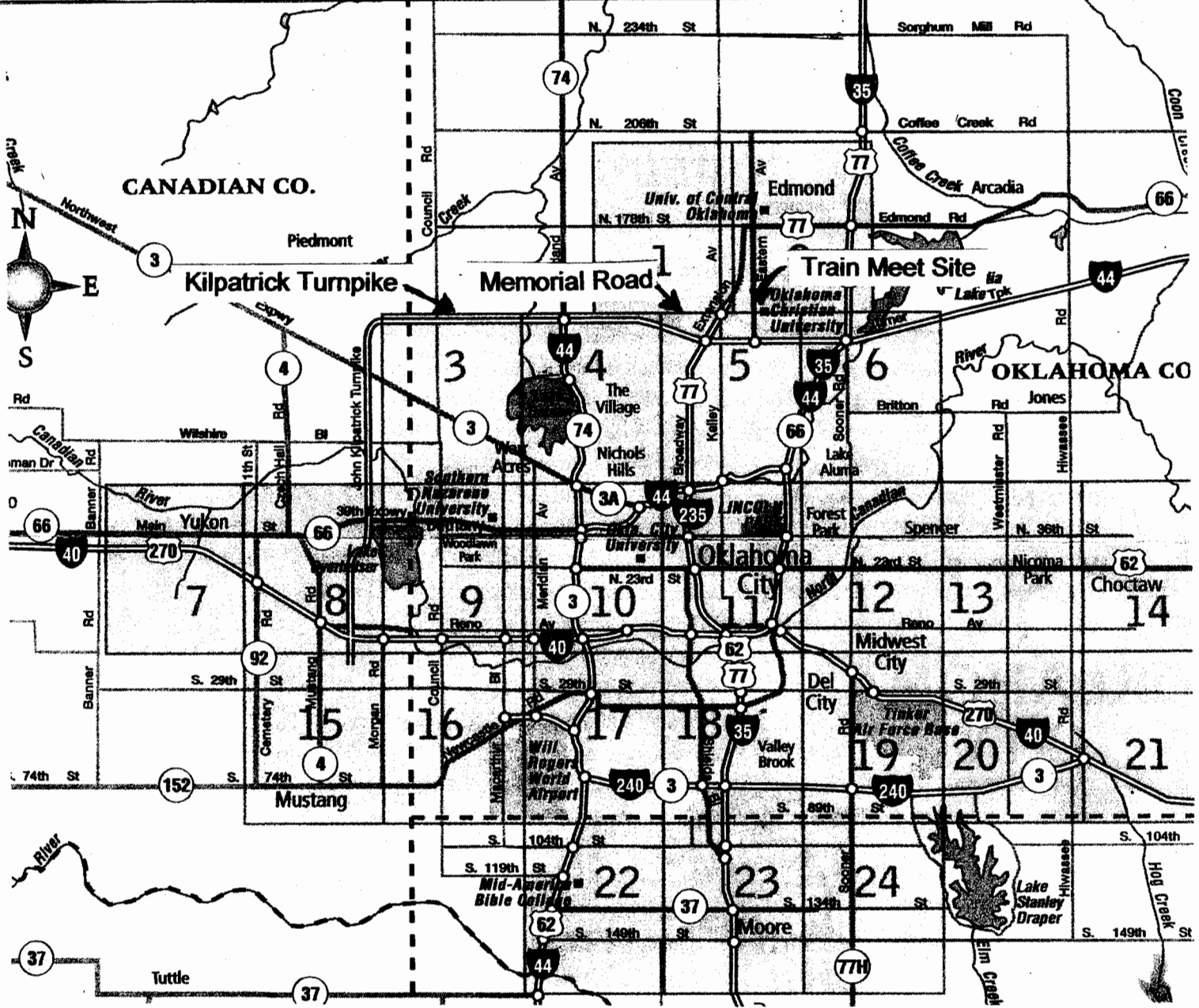

From Kilpatrick Turnpike, exit at Eastern Avenue, go north almost a mile to Memorial Road, go east on Memorial about one half mile, University will be on the north side. Follow the **TRAIN SHOW** signs from University Main Entrance to Edward L. Gaylord University Center

Train Related and Other Activities in the Oklahoma City Area

O SCALE LAYOUT. Our 30' by 30' club layout will be open during the train meet. It has two levels with narrow gauge on the top level and dual gauge on the bottom. Track on both levels is now operational but scenery is just getting started. Please visit, we are only a mile away from the train meet. Maps and times available at the meet.

OKLAHOMA RAILWAY MUSEUM. It is located at I-35 and Grand Blvd. on the east side of the city. THOMAS THE TANK ENGINE that tours the country is visiting our museum and will be giving rides both days of our meet. Anyone with kids or grandkids might want to check it out. Museum has a depot, locomotives, equipment and a 1.9 mile ride.

LOCO. This is a live steam group with an operating system located about 20 miles east of Oklahoma City. Sat. will be a work day and Sun. an operating day, both days open to us.

OMNIPLEX. This museum has a large operating O scale layout plus a lot of equipment in display cases. Location - NE 52nd St. and M.L. King Blvd. Open daily 9 - 5, Sat. 9 - 6, Sun. 12 - 6. Adult \$7.50, senior \$6.75.

OKLAHOMA CITY NATIONAL MEMORIAL. The Memorial to the victims of the Murrah Building Bombing is open 24 hours daily. The adjacent Museum is open 9 am - 6 pm Mon - Sat, 1 pm - 6 pm Sun.

NATIONAL COWBOY & WESTERN HERITAGE CENTER. Located on I-44 near M.L. King Blvd. Open everyday 9 am - 5 pm.

AMTRAK'S HEARTLAND FLYER.

Departs Fort Worth	5.25 pm	Departs Oklahoma City	8.25 am
Arrives Oklahoma City	9.39 pm	Arrives Fort Worth	12.39 pm

AMTRAK Reservations: 1-800-872-7245 (1-800-USA-RAIL)

EL RENO TROLLEY. The city of El Reno (about 30 miles west of Oklahoma City) has a trolley line featuring a restored 1924 streetcar. It runs from 10am - 4pm Wed thru Sat. and 1pm - 4pm Sun. It departs from the El Reno Railroad museum which is located in the old Rock Island station which has some good exhibits. Tickets are \$3 adult, \$1.50 children/over 65 and handicapped.

YUKON TROLLEY MUSEUM. Third and Main, Yukon is about 15 miles west of OKC

HOBBY SHOPS:

Whistle Stop Trains, 1313 West Britton Rd, OKC Ph: 842-4846

O scale estate sales, paint and scratch building supplies, Lionel, K-Line

Woodward's Arts Crafts Hobbies, 4401 W. Memorial Rd, OKC Ph: 751-4994

Full line of paint and scratch building supplies, Lionel